

PPAR FT UNDIP 001
 Redesigning the Marketplace into
 Q-Commerce Experiences for a Practical
 Future in 2050

KONTEKS ISU

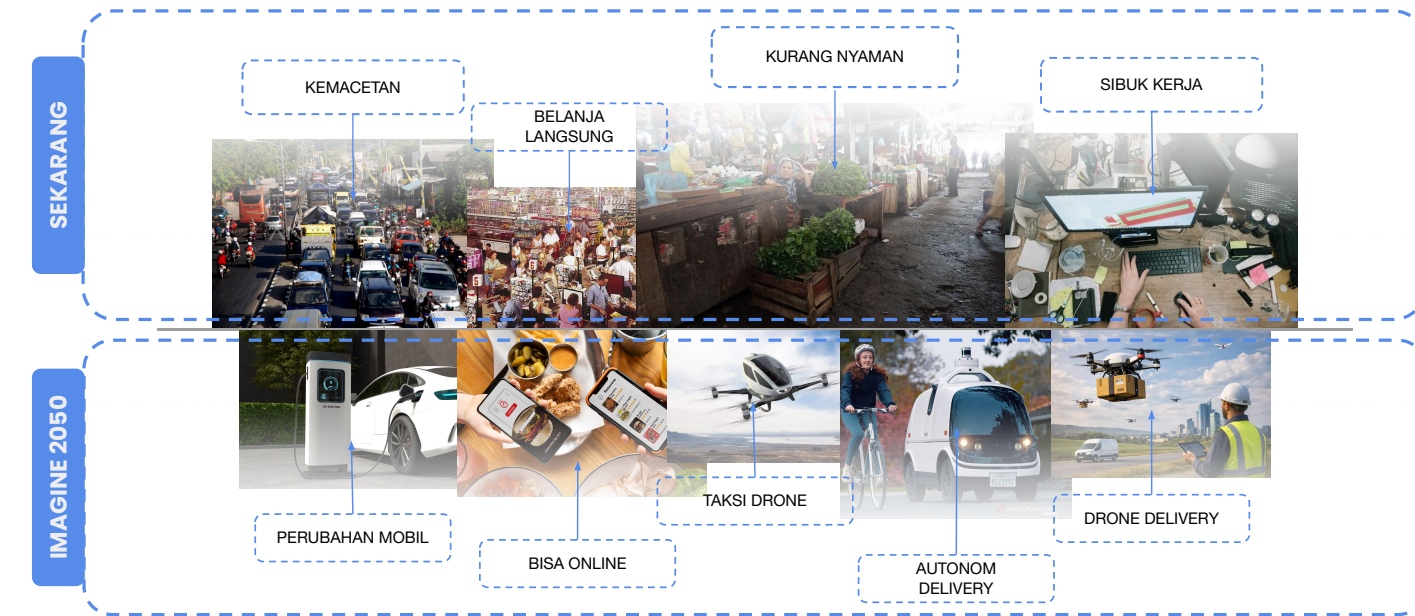

PROGRAMMING

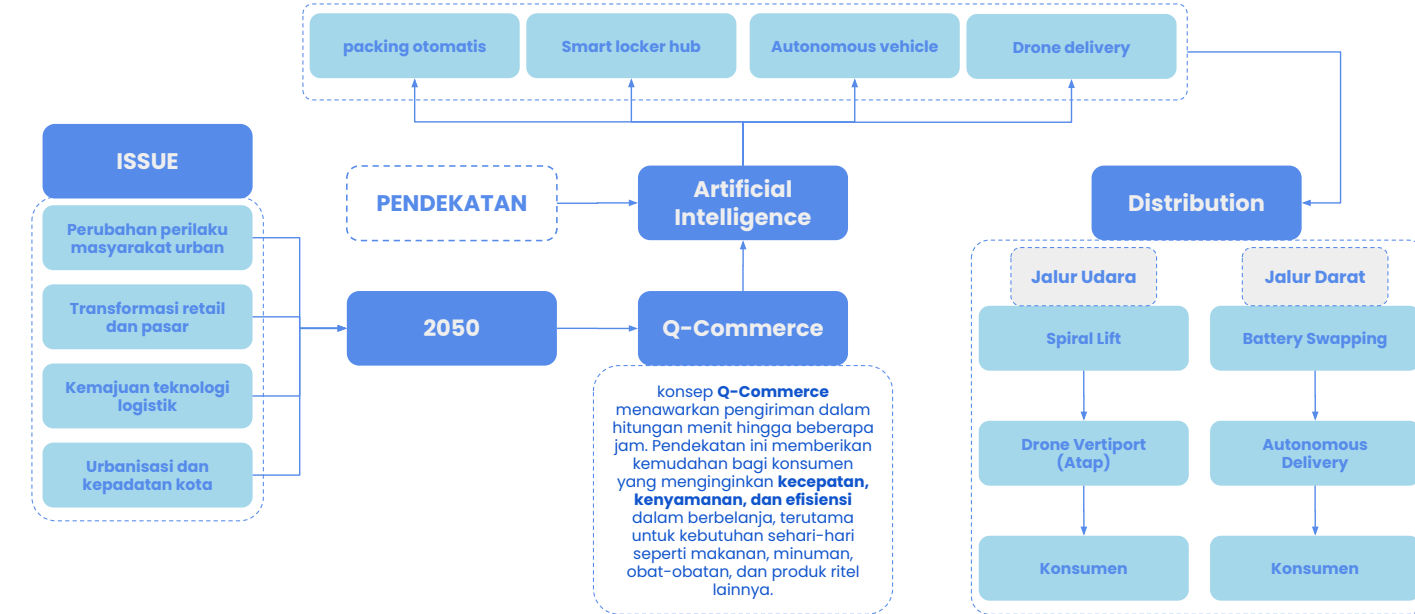

PROGRAM RUANG

KELOMPOK RUANG	LUASAN
LOADING & UNLOADING	3242.4 m ²
PENGELOLA	573.6 m ²
FOOD & BEVERAGES	587.6 m ²
SERVIS PENGELOLA	752.132 m ²
MEKANIKAL ELEKTRIKAL	62.47 m ²
TOTAL	5218.2 m²

HUBUNGAN RUANG

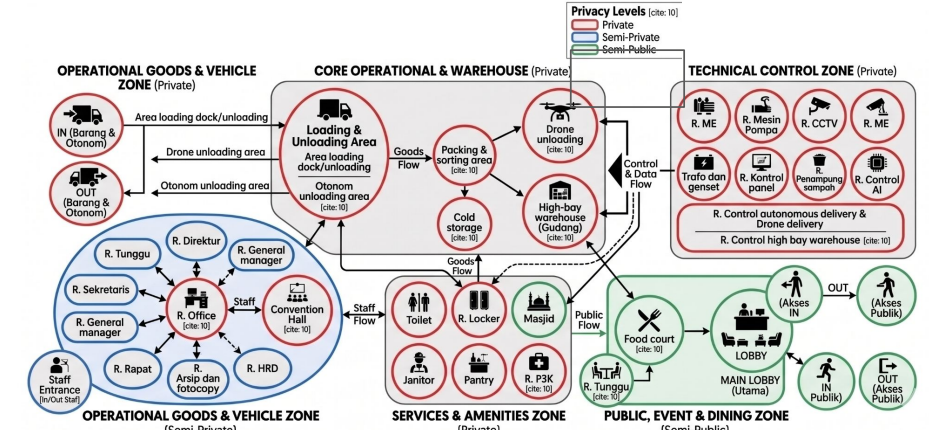

MATERIAL SEQUENCE

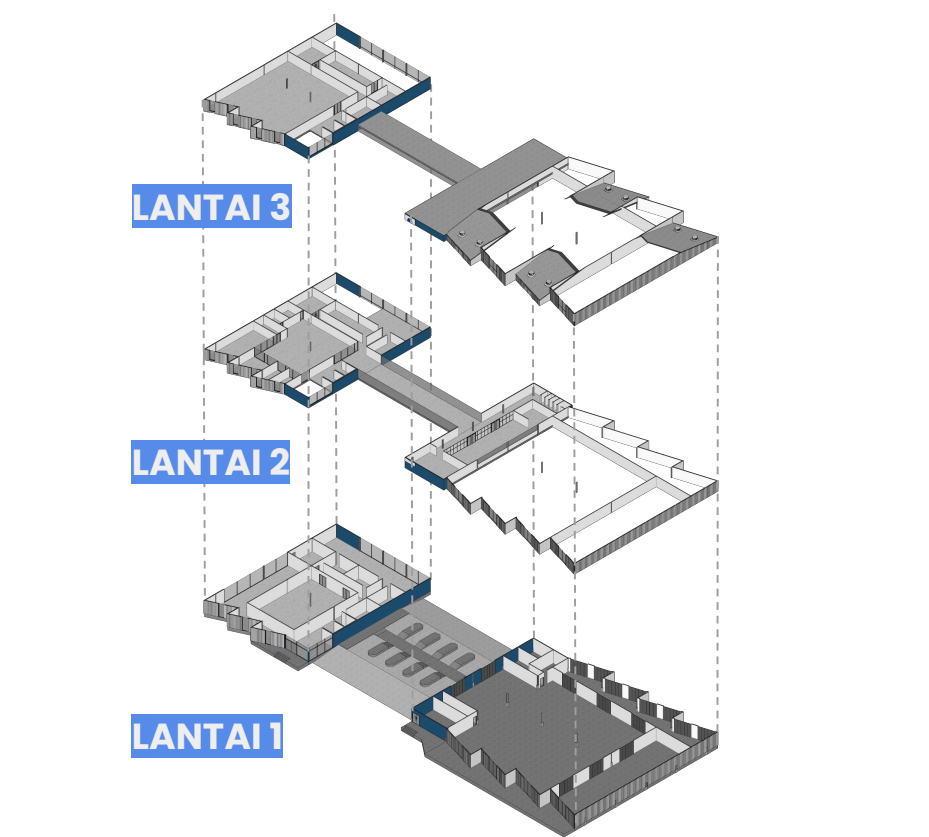

SKENARIO Q-COMMERCE WAREHOUSE ASTRO SEMARANG

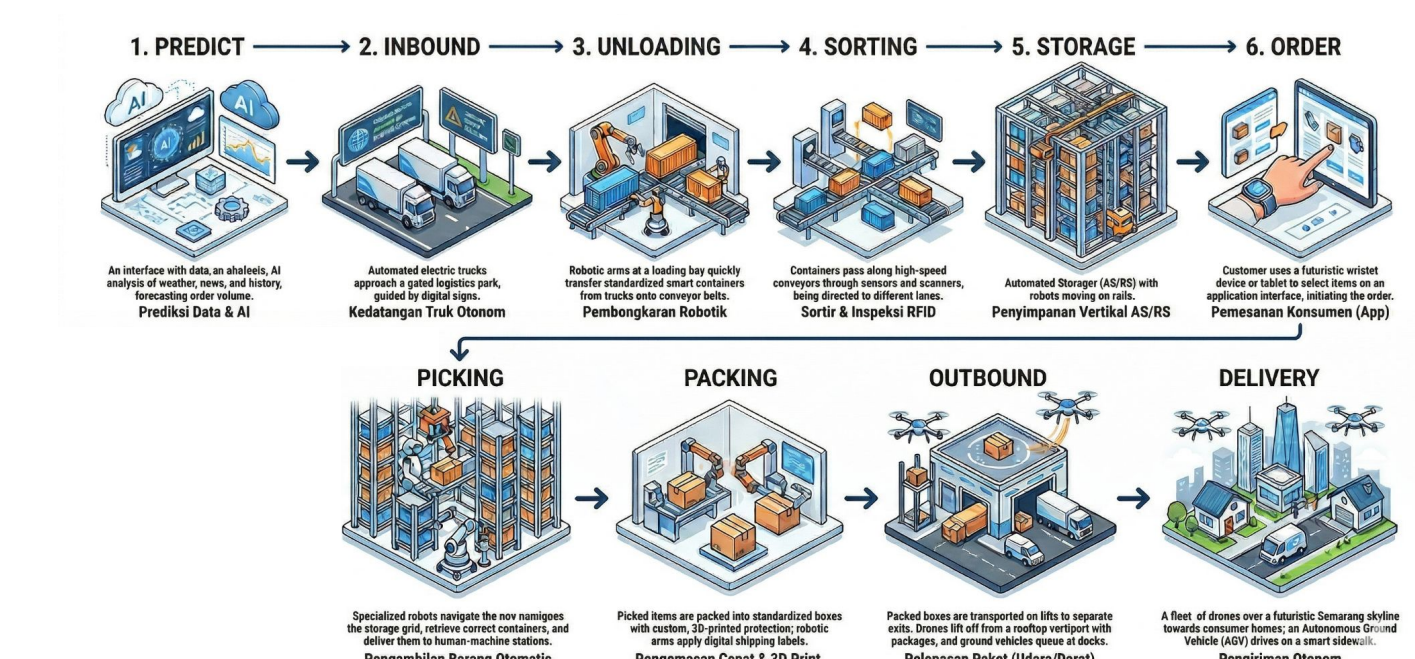

REFERENSI

- J. Lee, B. Bagheri, H. Kao, A Cyber-Physical Systems architecture for Industry 4.0 based manufacturing systems, Manuf. Lett. 3 (2015) 18–23. doi:10.1016/j.mfglet.2014.12.001.
- Kembro, J., Norrman, A., & Eriksson, E. (2018). Adapting warehouse operations and design to omni-channel logistics. International Journal of Physical Distribution & Logistics Management, 48(9), 890–912.
- Cowen, D. (2014). The Deadly Life of Logistics: Mapping Violence in Global Trade. University of Minnesota Press.



LOKASI

Lokasi : Bandarharjo, Semarang City, Central Java
 Topografi : Datar
 Orientasi : Barat Daya
 Posisi : Tepi Jalan
 Batas :
 Utara : Jalan
 Selatan : Jalan
 Timur : SPBU Pertamina
 Barat : Jalan

Data :
 Luas lahan : ± 15.625 sqm
 KDB : 60 %
 RTH : Min 20%
 KKOP : 30 m
 KLB : 1,8 – 3,6

GUBAHAN MASSA

