

LATAR BELAKANG



ANALISIS TAPAK



HASIL DESIGN

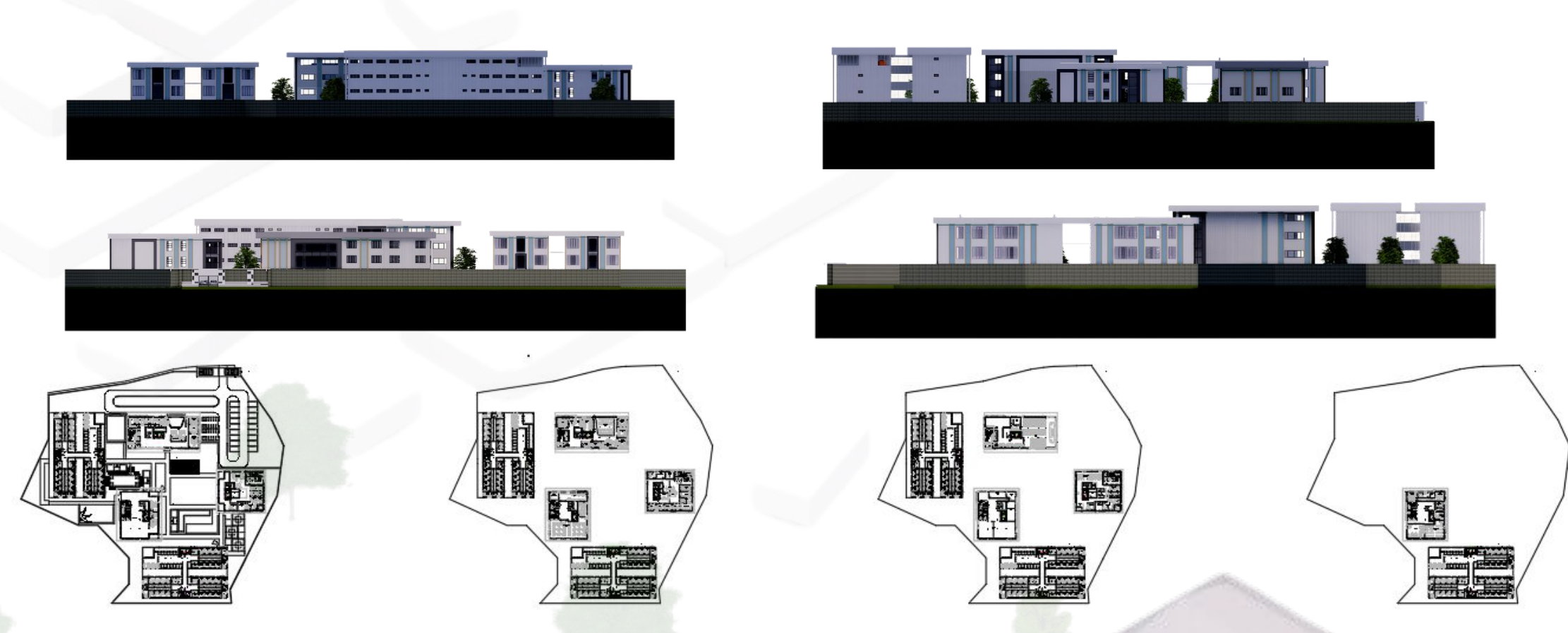

PROFIL PENGGUNA

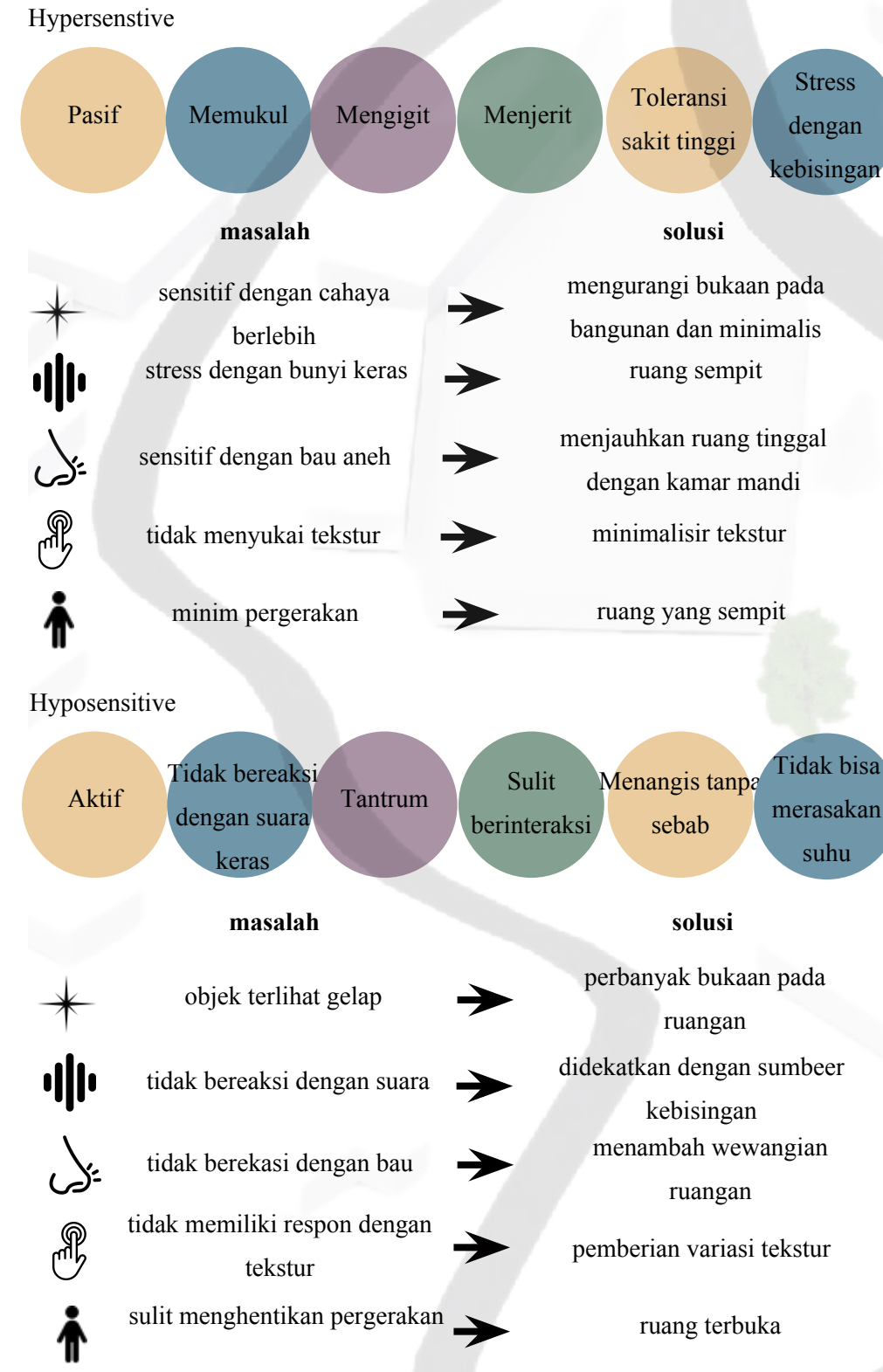

PENERAPAN KONSEP

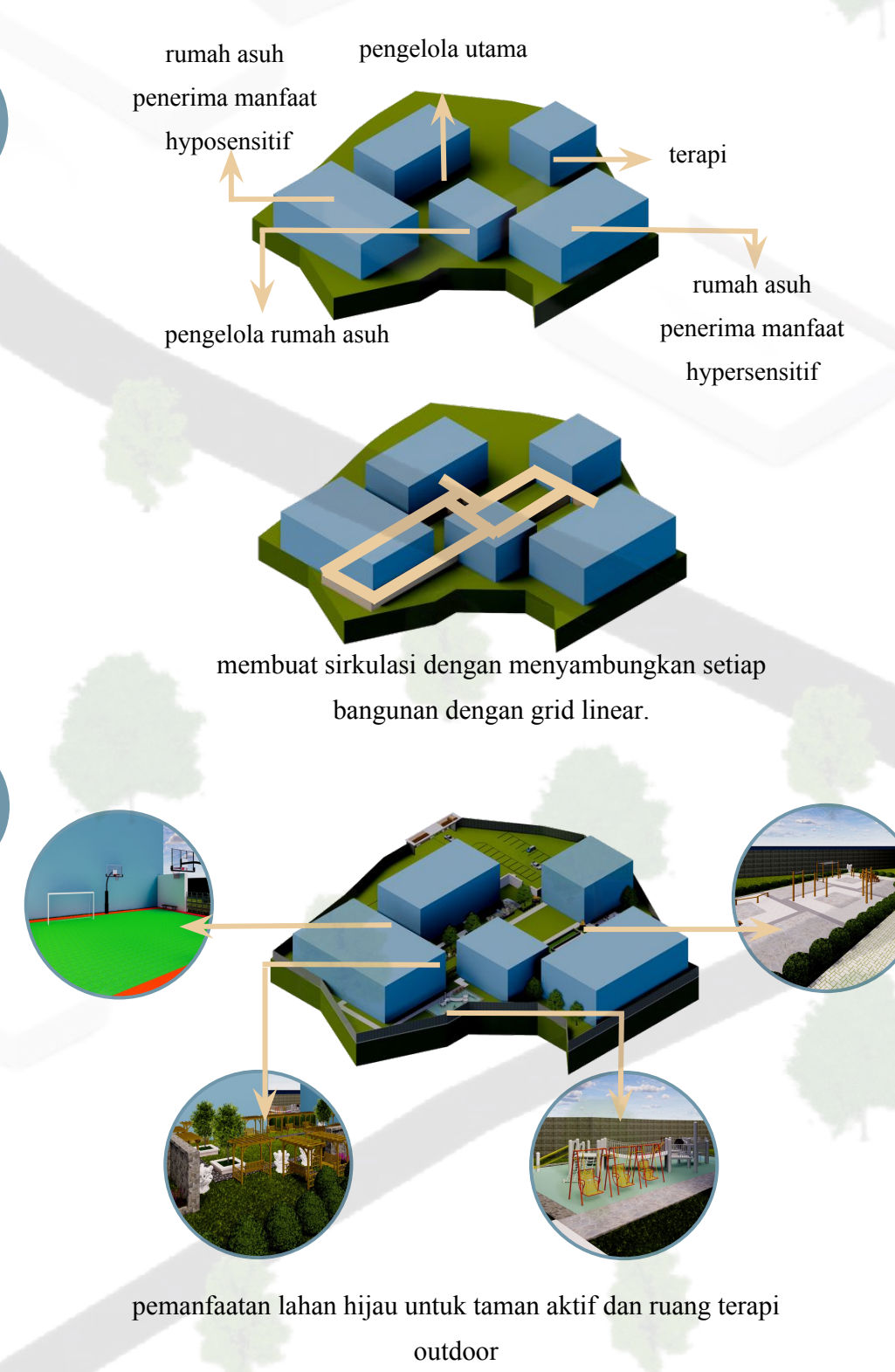

DAFTAR REFRENSI

Manchala, S. (2014). Center For Autistic on Architectural Intervention. Departemen of Architecture School of Planning and Architecture, Vijayawada.  
Mitra Yatim. (2021, August 28). Perbedaan Panti Asuhan dan Panti Sosial yang Wajib Anda Tahu. Retrieved February 19, 2023 from Hari Anak Yatim: <https://harianakyatim.com/perbedaan-panti-asuhan-dan-panti-sosial/>  
Mustofa, M. (2008). An Architecture for Autism: Concepts of Design Intervention for the Autistic User. Archnet-IJAR: International Journal of Architecture Research.  
Nike Ajeng Pradini & Wiwik Widadjati. (2016). Metode Floor Time Terhadap Penambahan Kosakata Anak Autis di SLB. Fakultas Ilmu Pendidikan, Universitas Negeri Surabaya.