

Presenting Dialogue of Light and Shadow in Constructing Wellness Space

PENDAHULUAN

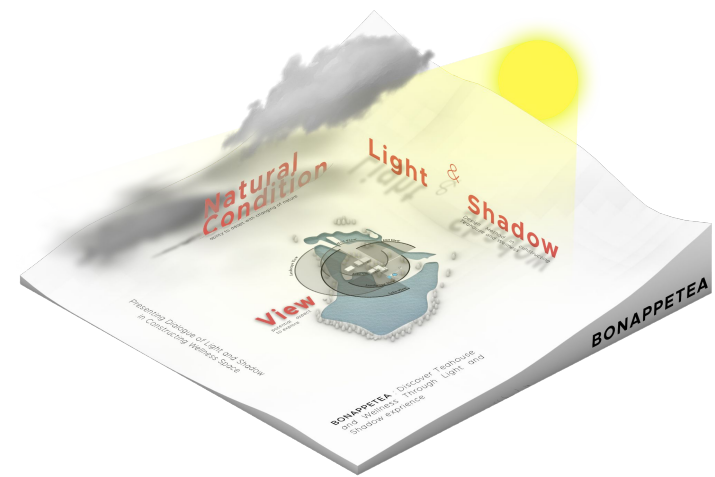

Kondisi alam memberikan banyak manfaat bagi kehidupan, salah satunya cahaya yang dalam arsitektur dapat memberikan mood dan kualitas suasana ruang yang spesifik.

KAJIAN ARCHITECTURE OF LIGHT

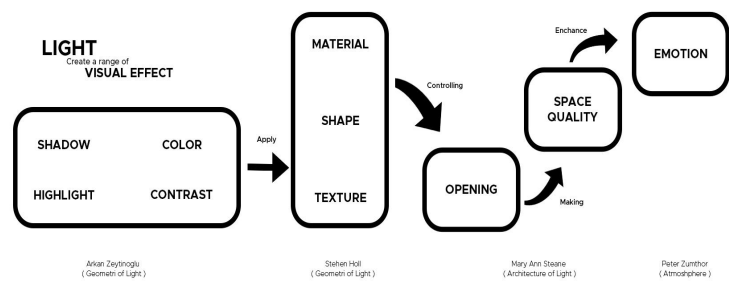

REFERENSI

Lobell, J., & Kahn, L. I. (1979). *Between silence and light: Spirit in the architecture of Louis I. Kahn*. Shambhala : distributed in the U.S. by Random House.

Phillips, D. (2004). *Daylighting: Natural light in architecture*. Architectural Press.

Steane, M. A. (2011). *The architecture of light: Recent approaches to designing with natural light*. Routledge.

Zeytinoglu, A. (2011). *Geometry of light: The architecture of Arkan Zeytinoglu*. Springer.

Zumthor, P. (2006). *Atmospheres: Architectural Environments Surrounding Objects*. Birkhauser.

KUALITAS RUANG DALAM



EKSPLORASI DAN ANALISIS CAHAYA

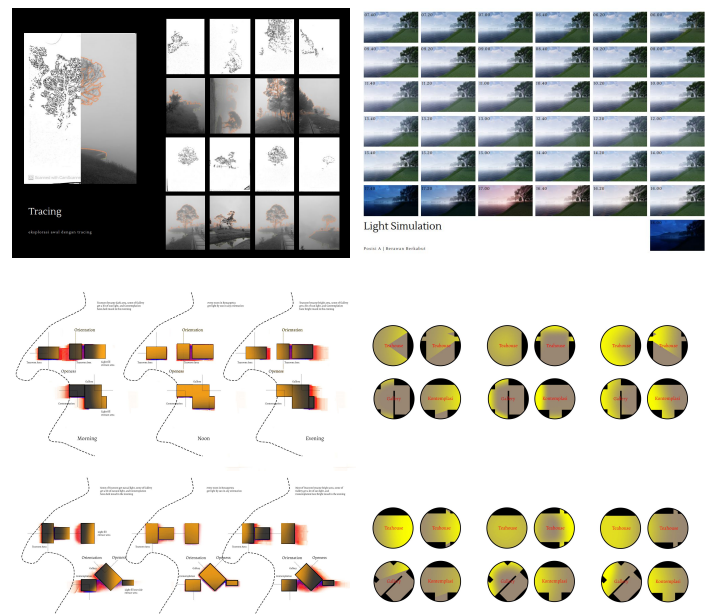

Eksplorasi konfigurasi massa bangunan melihat keterkaitan massa bangunan dengan kualitas ruang dalam

ANALISIS VIEW DAN PEMBAYANGAN

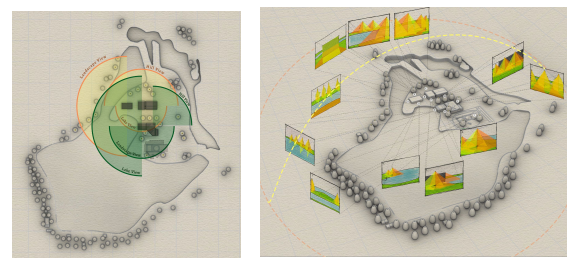

PROGRAMMING

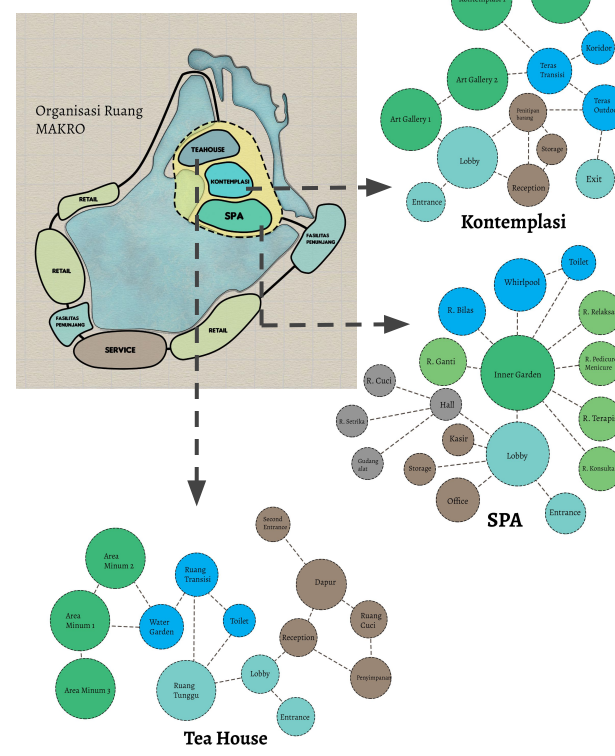

SKEMATIK POTONGAN

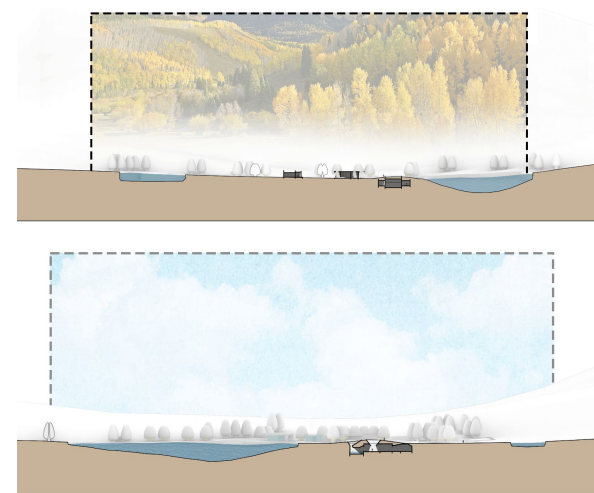

SKEMATIC BONAPPETEA

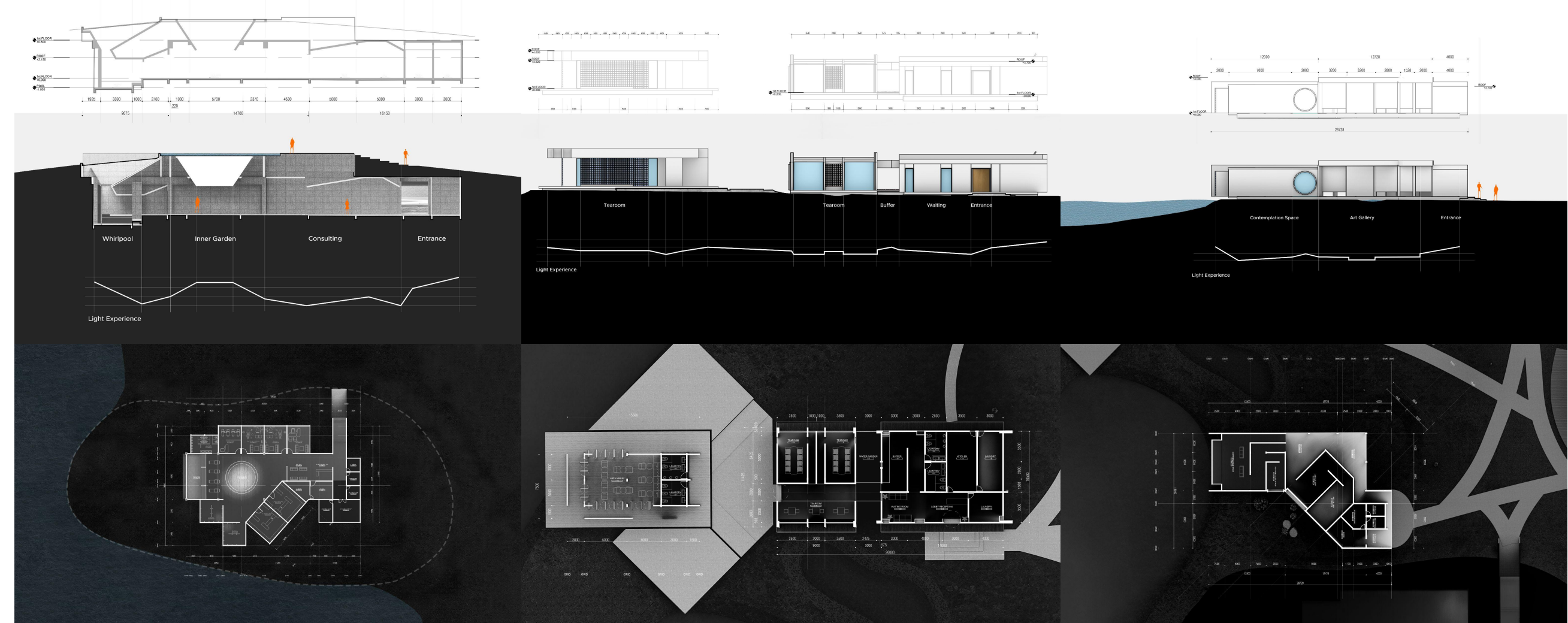

SIRKULASI DAN SUASANA

