

BACKGROUND



±50-60% of Batang community do informal work, those who work alone or not permanent employees who are not even paid.

Overall, more than 50% of workers in Batang have only graduated from elementary school.

The existence of globalization also triggers an influence on architecture at particular places or cities.

Young residents preferred to be part of Indonesian Workers Abroad as farmers or other laborers instead of farming in their homes.

Farmers' productivity has decreased by seeing the interest of young people to continue their careers as farmers or professionals in this field.



GOALS

- Education Platforms: To improve human resource & agriculture quality.
- Empowering and contributing local farmers.
- Indonesian Architecture: Increasing culture awareness.

SITE INFORMATION

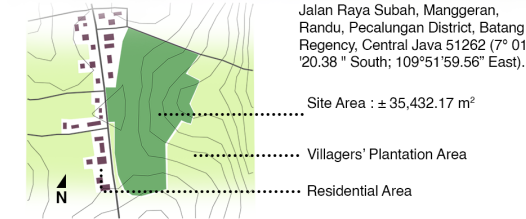

SITE PLAN

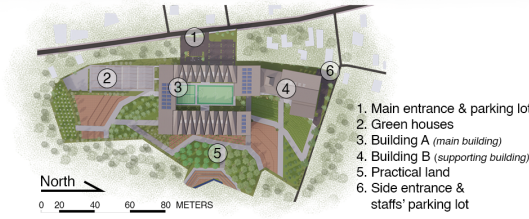

FLOOR PLANS



SITE ANALYSIS

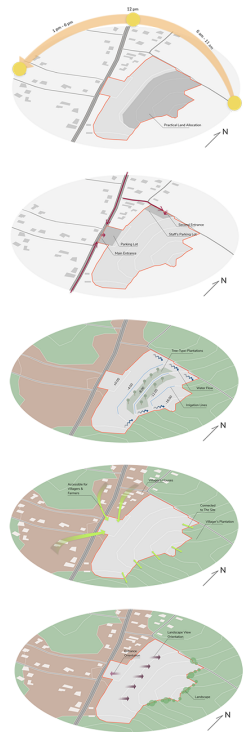

Sunlight
 Allocating greenhouses and practical land in the east side. Shading or secondary skin implementation in the east and west part.

User Accessibility
 Main entrance and side entrance allocation. Welcoming area near the road and parking area can be reached through side entrance.

Contoured Land
 Do recontouring through cut & fill and retaining wall. Constructing irrigation or water distribution to the east, and tree-type plantation allocation on the site's center to maintain overflowing water.

Contextual
 The site is accessible for the villagers and the farmers. The site is connected to the villagers' plantations, so the school could empower the local farmers.

View and Orientation
 Allocating open space to experience the view in the east part of the site. Building orientation is on to the west, near the main street and the settlement.

ZONING

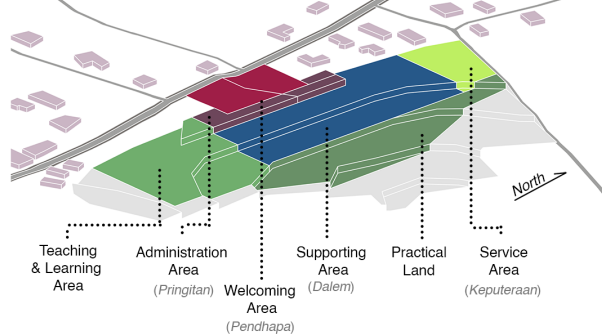

MASS TRANSFORMATION

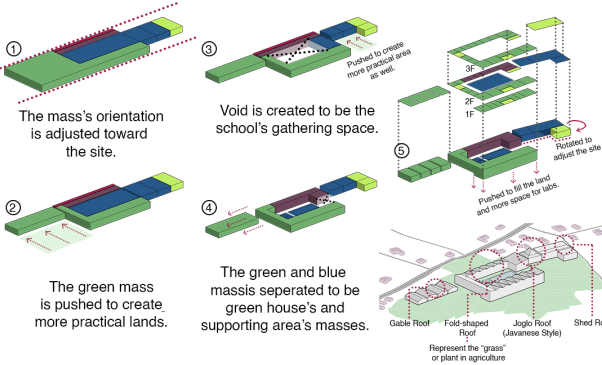

CONCEPT DIAGRAM

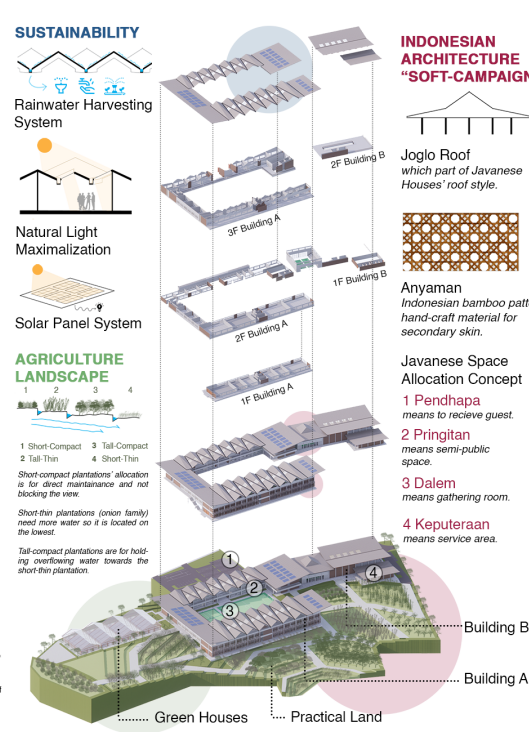

SECTION PLANS

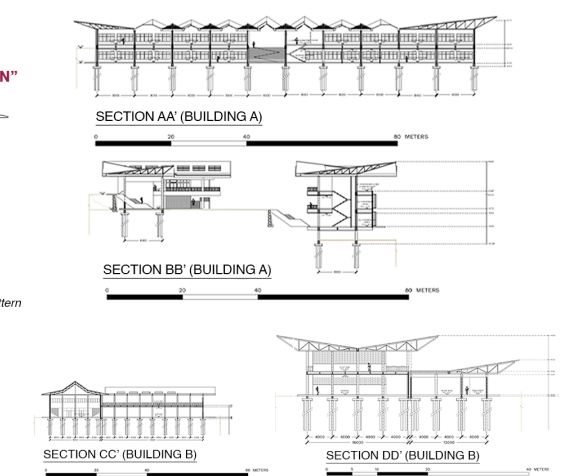

ELEVATIONS

